

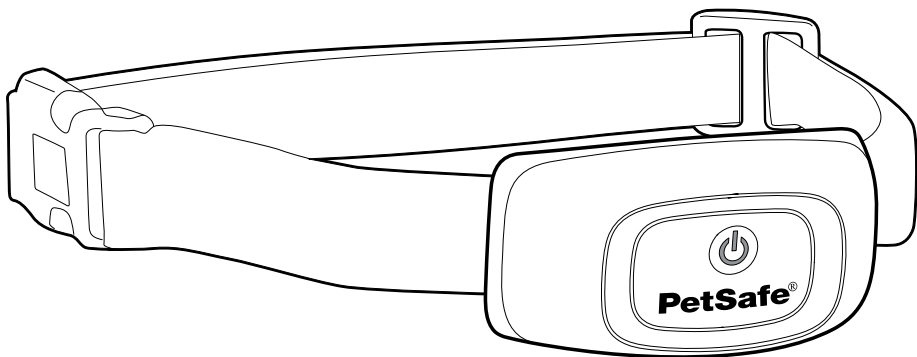

Product Manual

PBC00-16634

Bark Collar



Please read this entire Product Manual before beginning.

Welcome

You and your pet were made for each other. Our aim is to help you have the best companionship and the most memorable moments together. Your PetSafe® Bark Collar is designed to safely and humanely eliminate nuisance barking.

We know that safe pets make happy owners. Before getting started, please take a moment to read through the important safety information. If you have any questions, please don't hesitate to contact us.

Hereinafter Radio Systems Corporation and any other affiliate or Brand of Radio Systems Corporation may be referred to collectively as "We" or "Us".

IMPORTANT SAFETY INFORMATION

Explanation of Attention Words and Symbols used in this Guide



This is the safety alert symbol. It is used to alert you to potential personal injury hazards. Obey all safety messages that follow this symbol to avoid possible injury or death.

⚠ WARNING

WARNING indicates a hazardous situation which, if not avoided, could result in death or serious injury.

⚠ CAUTION

CAUTION, used with the safety alert symbol, indicates a hazardous situation which, if not avoided, could result in minor or moderate injury.

CAUTION

CAUTION, used without the safety alert symbol, indicates a hazardous situation which, if not avoided, could result in harm to your pet.

⚠ WARNING

Do not use this product if your dog is aggressive, or if your dog is prone to aggressive behavior. Aggressive dogs can cause severe injury and even death to their owner and others. If you are unsure whether this product is appropriate for your dog, please consult your veterinarian or a certified trainer.

There is a risk of explosion if a battery is replaced by an incorrect type. Do not short circuit, mix old and new batteries, dispose of in fire or expose to water. When batteries are stored or disposed, they must be protected from shorting. Dispose of used batteries properly.

⚠ CAUTION

This product is not a toy. Keep it away from the reach of children. Use it only for its bark stopping purpose.

CAUTION

- Proper fit of the collar is important. A collar worn for too long or made too tight on the pet's neck may cause skin damage ranging from redness to pressure ulcers. This condition is commonly known as bed sores.
- Avoid leaving the collar on a pet for more than 12 hours per day.
- When possible reposition the collar on the pet's neck every 1 to 2 hours.
- Regularly recheck the fit to prevent excessive pressure; follow the instructions in this manual.
- You may need to trim the hair in the area of the contact points. However, never shave the dog's neck; this may lead to a rash or infection.
- Never connect a leash to a collar with contact points. It will cause excessive pressure on the contact points.
- When connecting a leash to a separate collar, do not allow it to put pressure on the receiver collar.
- Wash the dog's neck area and the contact points of the collar weekly with a damp cloth.
- Examine the contact area daily for signs of a rash or a sore.

- If a rash or sore is found, discontinue using this product until the skin has healed.
- If the condition persists beyond 48 hours, see your veterinarian.
- For additional information on bed sores and pressure necrosis, please visit our website.

This product is only for use with healthy pets. If you're not certain that your pet is in good health, we recommend that you take your pet to a veterinarian before using this product.

What's Covered

In the Box.....	4
How it Works	4
Insert and Remove the Battery.....	4
Fit the Collar.....	5
Temperament Learning	5
Test the Collar	6
What to Expect During Use.....	6
Frequently Asked Questions.....	7
Customer Care.....	7
Terms of Use and Limitation of Liability.....	7
Warranty	8
Battery Disposal.....	8
Important Recycling Advice	8
Compliance	8
THIS PRODUCT INCLUDES A "NO BARK GUARANTEE"	9

In the Box

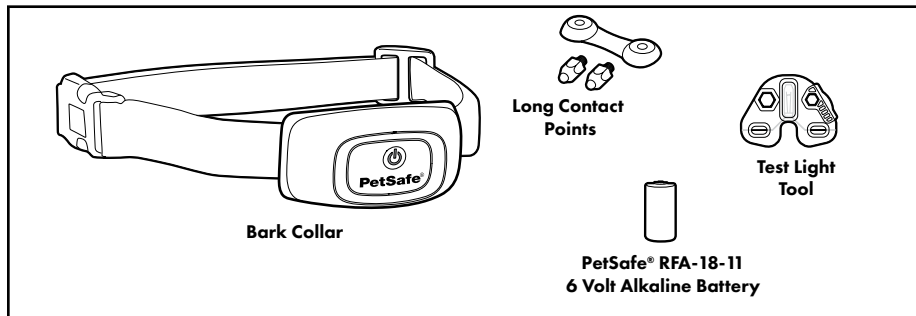

How it Works

The PetSafe® Bark Collar has 15 levels of static correction. It begins with low-level corrections. If excessive barking continues, the correction intensity will increase with each successive bark until the barking stops. Once the dog has learned to reduce the barking, the initial warning corrections are reduced. As a built-in safety feature, if your dog barks 15 times or more within a 1 minute 20 second period, the bark collar will automatically shut off for 3 minutes.

Insert and Remove the Battery

1. Turn the battery door counter-clockwise using the test light tool or a coin (**1A**).
2. Insert the 6-volt alkaline battery, negative (-) end first (**1B**).
3. Replace the battery door turning clockwise (**1C**).
4. This Bark Collar utilizes a replaceable PetSafe® RFA-18 6 Volt Alkaline battery. A replacement battery can be found at many retailers. Contact the Customer Care Center or visit our website at www.petsafe.com.

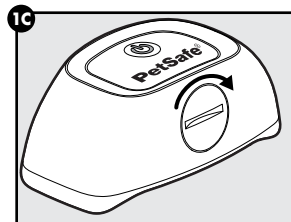
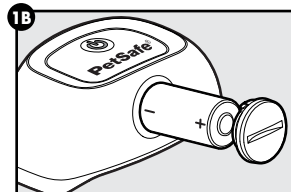
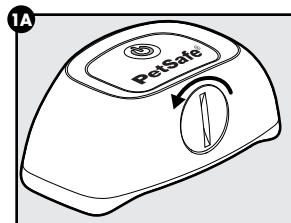

Battery Life

Average battery life is 3 to 6 months, depending on how often your dog barks. However, due to greater use during your dog's training, your first battery may not last as long as replacement batteries. Be sure to discard the used battery properly.

Two-Color LED

The two-color LED indicator shows good or low battery. Good battery is indicated by 1 flash every 5 seconds with green LED. Low battery is indicated by 3 flashes every 5 seconds with the red LED. If there are no LED lights it is time to change the battery.

To Turn the Collar On

Press and hold the power button until you hear a low to high beep and the green LED appears, and then release. The green LED will flash once every 5 seconds.

To Turn the Collar Off

Press and hold the power button until the bark collar beeps high to low, and then release. The red LED will be illuminated during the button press and will turn off when the bark collar turns off.

Quick Tip: When not using the collar, turn it off to extend battery life.

Fit the Collar

Important: The proper fit and placement of the bark collar is important for effective operation. The contact points must have direct contact with your dog's skin on the underside of his neck.

1. Make sure that the collar is turned off.
2. Start with your dog standing comfortably (2A).
3. Place the collar on your pet so that the PetSafe® logo is right side up and the collar is directly under your dog's chin. Center the contact points underneath your dog's neck, touching the skin (2B). **NOTE:** It is sometimes necessary to trim the hair around the contact points to make sure that contact is consistent. However, you should never shave your pet's neck as this may increase risk of skin irritation.
4. Check the tightness of the collar by inserting one finger between the end of a contact point and your dog's neck (2C). The fit should be snug but not constricting.
5. Allow your dog to wear the collar for several minutes, and then recheck the fit. Check the fit again as your dog becomes more comfortable with the collar.

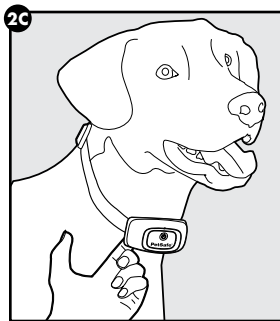
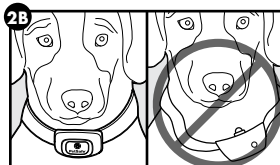
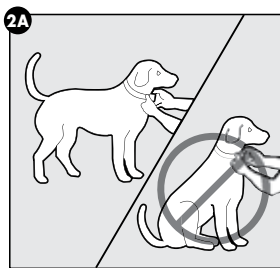

CAUTION

Do not shave the pet's neck as this may increase the risk of skin irritation. The collar should not be worn for more than 12 hours out of every 24-hour period. Leaving the collar on too long could lead to skin irritation.

Temperament Learning

Temperament Learning tracks the number of corrections needed to substantially reduce (and in most cases) eliminate the number of nuisance barks. The collar starts at the lowest correction level and increases the intensity with each successive bark until the barking stops. This correction level becomes the starting level the next time the dog barks. Once your dog has learned to reduce this barking, the initial warning corrections are automatically reduced.

NOTE: As a built-in safety feature, if your dog barks 15 times or more within an 80 second period, the bark collar will automatically shut off for 3 minutes.

Reset the Correction Level to Level 1

1. Power the collar on. Wait 5-10 seconds or until the first green LED flash.
 2. Press and hold the on/off button.
 3. Continue holding through the red LED and power off tone.
 4. The green LED will flash 5 times to confirm the correction level has been reset to level 1.
 5. Release the on/off button. The bark collar will now be powered off.
-

Test the Collar

1. Begin with the collar off.
 2. Push and hold the power (on/off) button. The collar will beep and the LED will illuminate green. Release the power button after the beep.
 3. The green LED will flash twice. Push and hold the on/off button. The LED will illuminate red.
 4. Continue to press the on/off button until the collar beeps. The LED will turn off. Continue to press the on/off button.
 5. The blue LED will appear to indicate the collar is now in Test Mode.
 6. Release the on/off button. The collar will beep, once for each level of correction, up to level 15. Then, it will sound the normal power off tone and turn itself off.
 7. The test can be stopped at any time by pressing the on/off button.
-

What to Expect During Use

Important: Do not leave your dog alone the first few times he receives a correction.

Place the collar properly on your dog and wait nearby until he barks. Most dogs will understand very quickly that the collar is disrupting their urge to bark and will relax and stop barking. Because the static correction may be surprising or startling at first, some dogs may bark more at the initial correction.

On rare occasions, a dog may begin barking at the correction. If this happens, reassure your dog with a calm voice. As your dog relaxes, he will understand that if he becomes quiet, he will not receive any more static corrections. Dogs that have this reaction typically will only have it the first time they wear the bark collar.

You should notice a reduction in your dog's barking within the first couple of days that he wears the bark collar. At this point, it is important to remember the learning process is still not complete. Dogs will "test" this new learning experience and may increase their attempts to bark. This usually occurs during the second week a dog wears the bark collar. If this does occur, remain consistent and do not alter your use of the bark collar. You must place the bark collar on your dog in every situation when you expect him to be quiet. If your dog is not wearing the bark collar, he may resume barking and his learning will suffer a setback.

FREQUENTLY ASKED QUESTIONS

How old does a pet have to be before using the bark collar?	<ul style="list-style-type: none">Your pet should be at least 6 months old before using the bark collar. The collar may be too large for dogs under 8 lb.
Will the bark collar work for my dog?	<ul style="list-style-type: none">The bark collar is safe and effective for most breeds and sizes of dogs, though it may be too large for dogs under 8 lb. to wear comfortably.
Can I attach a leash to the bark collar?	<ul style="list-style-type: none">No. This can result in pulling the contact points too tightly against your dog's neck. Attach a leash to a separate, non-metallic collar or a harness, making sure the extra collar does not put pressure on the contact points.

Customer Care

USA & Canada - Tel: +1 (800) 732-2677

Monday - Friday 8 AM - 8 PM / Saturday 9 AM - 5 PM (EST)

Terms of Use and Limitation of Liability

1. Terms of Use

The use of this product is subject to your acceptance without modification of the terms, conditions and notices contained with this product. Use of this product implies acceptance of all such terms, conditions, and notices. If you do not wish to accept these terms, conditions, and notices, please return the product, unused, in its original packaging and at your own cost and risk to the relevant Customer Care location together with proof of purchase for a full refund.

2. Proper Use

Proper Use includes, without limitation, reviewing the entire Product Manual and any specific safety information statements. The specific temperament or size/weight of your pet may not be suitable for this product. If you are unsure whether this product is appropriate for your pet, please consult your veterinarian or certified trainer prior to use. For products used with pets where training is desired, Radio Systems Corporation recommends that these training products are not used if your pet is aggressive and accepts no liability for determining suitability in individual cases.

3. No Unlawful or Prohibited Use

This product is designed for use with pets only. This product is not intended to harm, injure or provoke. Using this product in a way that is not intended could result in violation of Federal, State or local laws.

4. Limitation of Liability

In no event shall Radio Systems Corporation or any of its associated companies be liable for (i) any direct, indirect, punitive, incidental, special or consequential damage and/or (ii) any loss or damages whatsoever arising out of or connected with the use or misuse of this product. The Purchaser assumes all risks and liability from the use of this product to the fullest extent permissible by law.

5. Modification of Terms and Conditions

Radio Systems Corporation reserves the right to change the terms, conditions and notices governing this product from time to time. If such changes have been notified to you prior to your use of this product, they shall be binding on you as if incorporated herein.

Warranty

One Year Non-Transferrable Limited Warranty

This product has the benefit of a limited manufacturer's warranty. Complete details of the warranty applicable to this product and its terms can be found at www.petsafe.com.



Battery Disposal

- Separate collection of spent batteries is required in many regions. Check the regulations in your area before discarding spent batteries.
 - At the end of the product life, please contact one of our Customer Care Centers to receive instructions on proper disposal of the unit. Please do not dispose of the unit in household or municipal waste.
 - For a listing of Customer Care Center telephone numbers in your area, visit our website at www.petsafe.com.
-



Important Recycling Advice

Please respect the Waste Electrical and Electronic Equipment regulations in your country. This equipment must be recycled. At the end of the product life, do not place it in the normal municipal waste system. Please check the regulations in your area or return it to where it was purchased so that it can be placed in our recycling system. If these options are not possible, please contact the Customer Care Center for further information.

Compliance

FCC

This device complies with part 15 of the FCC Rules. Operation is subject to the following two conditions: (1) This device may not cause harmful interference, and (2) this device must accept any interference received, including interference that may cause undesired operation.

CAUTION: Modification or changes to this equipment not expressly approved by Radio Systems Corporation may void the user's authority to operate the equipment.

NOTE: This equipment has been tested and found to comply with the limits for a Class B digital device, pursuant to part 15 of the FCC Rules. These limits are designed to provide reasonable protection against harmful interference in a residential installation. This equipment generates, uses, and can radiate radio frequency energy and, if not installed and used in accordance with the instructions, may cause harmful interference to radio communications. However, there is no guarantee that interference will not occur in a specific installation. If interference does occur to radio or television reception, which can be determined by turning the equipment off and on, the user is encouraged to try to correct the interference by one or more of the following measures:

- Reorient or relocate the receiving antenna.
- Increase the separation between the equipment and the receiver.
- Connect the equipment to an outlet on a circuit different from that to which the receiver is connected.
- Consult customer care, the dealer, or an experienced radio/TV technician for help.

THIS PRODUCT INCLUDES A “NO BARK GUARANTEE”

Some dogs may not be responsive to static correction. If the PetSafe® Bark Collar is not meeting your needs, please contact our Customer Care team to find a product that works for you and your pet.

This product also includes a one year warranty.

Call our USA-based Customer Care Center

USA & Canada - Tel: +1 (800) 732-2677

Monday - Friday 8 AM - 8 PM / Saturday 9 AM – 5 PM (EST)

Radio Systems Corporation
10427 PetSafe Way
Knoxville, TN 37932
+1 (800) 732-2677
petsafe.com
SH400-2273/1

©2018 Radio Systems Corporation

DOCUMENT INFORMATION

Part Number / Revision: _____ Revision Description: _____
Created by: _____ Category Contact: _____
Initial Release to Production ECO Number: _____

PRINTING SPECIFICATIONS

Material: _____
Printing/Ink Colors: _____
Finishing: _____

APPROVAL

Vendor Name: _____ Submitted by: _____ / _____ / _____
RSC Evaluator: _____ / _____ / _____

COMMENTS (IF APPLICABLE)