

Quick Start Guide

Model FP-BEEPER

Step 1

Power Up

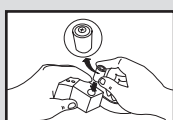

Insert 3v lithium battery in the collar receiver, positive (+) side out. Replace metal cap; do not over-tighten.

Step 2

Turning the Collar ON and OFF

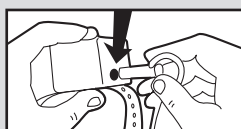

Briefly touch the magnet key (included) to the red paper dot to turn the collar on/off.

ON – a brief solid green light and tone indicate that the collar is on. Following the initial ON tone, you will hear a number of beeps, reflecting the Mode Number that the collar was last in (see chart). For example, an initial long tone followed by 3 beeps indicates that the unit is in Mode No. 3: Silent mode, soft volume.

OFF – A brief solid red light and tone will indicate the collar has been turned off. First become familiar with the beeper mode table shown below and determine which of the 8 modes you would like to use. Example: Mode No. 2 is standard tone, run and point, loud volume.

Step 3

Changing the Operating Mode

With the unit OFF, touch the magnet key to the red paper dot and CONTINUE holding it in place.

While you are holding the magnetic key to the red paper dot, you will see LED flashes and hear audible tones as follows:

- 1) A brief solid green LED and long tone indicate the collar is on.
- 2) The green LED flashes, and the unit emits audible beeps, per the number in the table below. For example, 3 short flashes and beeps indicate that the unit is in Mode 3: standard tone, point only, soft volume.
- 3) The LED then turns solid amber.
- 4) Now pull the magnetic key away. A long tone sounds. You may now set a new mode of your choice. In this example, set Mode No. 2.
- 5) Within 5 seconds of the solid amber LED and long tone, move the magnetic key back to the red dot and hold it in place. The amber LED changes to flash green, the speaker emits audible tones. After 2 beeps/flashes, pull the magnet away.
- 6) The LED flashes green and speaker emits audible tones to confirm the mode. In our example, 2 beeps/flashes confirm Mode No. 2.
- 7) Turn the collar OFF before putting it on your dog.

In general, touch the magnet key to the red paper dot and CONTINUE holding until the LED turns amber. Pull the magnet key away. Within 5 seconds, move the magnet key back to the red dot and hold it in place to set one of 8 programmed modes. The number of beeps and green flashes indicates the mode per the table below. Pull away the magnet after the desired number of beeps are heard to program the mode you want. Try different modes to discover the one that works best for you.

No of Beeps	Mode type	Volume	Running Duration	Pointing Duration
1.	Single beep "run and point"	Soft	Every 10 seconds	Every Second
2.	Single beep "run and point"	Loud	Every 10 seconds	Every Second
3.	Silent "point only" single beep	Soft	No tone	Every Second
4.	Silent "point only" single beep	Loud	No tone	Every Second
5.	Warble "run and point"	Soft	Every 10 seconds	Every Second
6.	Warble "run and point"	Loud	Every 10 seconds	Every Second
7.	Silent "point only" warble	Soft	No tone	Every Second
8.	Silent "point only" warble	Loud	No tone	Every Second

Note: The unit's memory holds the last mode set, so that it's ready to go when you are.

Run and Point mode
(Mode No. 1, 2, 5, or 6)

- 1 beep per 10 seconds while dog is running.
- 1 beep every second while dog is still (likely on point).
- Choose from Standard or Warble tone.
- Choose from Soft or Loud Volume.

Silent mode Point Only
(Mode No. 3, 4, 7, or 8)

- Silent while dog is running.
- 1 beep every second while dog is still (likely on point)
- Choose from Standard or Warble tone.
- Choose from Soft or Loud Volume.

Step 4

Fit the Collar to your Dog

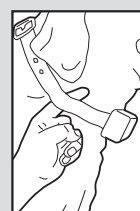

Proper Fit: The collar fit should be snug, yet loose enough to allow one finger to fit between the strap and the dog's neck. Fit is important because a loose collar may move on the neck. It's okay to trim any excess strap length.

Proper Fit: The collar strap fit should be snug, yet loose enough to allow one finger to fit between the strap and dog's neck.

Step 5

Turn the Collar ON

Turn the collar ON when it's fitted to your dog and you are ready to go.

Rugged All-Terrain Beeper

Model FP-BEEPER

Understanding the Receiver

Your tracking beeper consists of a Durapro™ collar strap which features a collar speaker, and a small receiver box, which houses the battery and computerized electronics that control the beeper. Do not attempt to remove either the speaker or receiver from the strap. Use the magnet key to turn the unit ON and OFF, and set beeper modes. The Rugged All-Terrain Beeper is waterproof and submersible.

The collar receiver uses a LED light to let you know the status of the receiver:

- Blinking green light – collar is ON and operational
- Solid red light – turning collar OFF
- Blinking red light – low battery; change as soon as possible
- Amber light – programming mode

Understanding the Beeper

The beeper is connected to the collar receiver via wires running through the collar strap. Take care not to cut the strap or damage these wires. The beeper is waterproof. It requires very little maintenance besides checking the slots occasionally and removing debris.

Replacement Batteries

Your Rugged All-Terrain Beeper uses a 123-size 3-volt lithium battery. These are commonly available where you bought your training system, where batteries are sold, or call 1-800-826-5527 to order direct from us. When you replace the battery the beeper will lose its programming. Follow Quick Start Step 3 to reset operating mode.

Troubleshooting

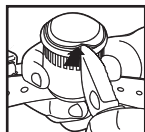

If volume is muted after submerging in water, turn the beeper speaker to drain the water.

If debris reduces speaker volume, gently pry out the black rubber ring from the top cap of the speaker. Pull the body of the speaker upwards until the slots are above the top cap. Clean debris from slots and reassemble, setting the rubber ring in its slot.

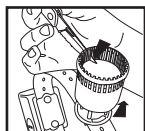

If you cannot solve the problem by following these steps, please call 1-800-826-5527.

Compliance with U.S. Telecommunications Regulations

This INNOTEK® Rugged All-Terrain Beeper is designed to meet requirements set forth by United States country telecommunications authorities. Note that in some countries, use may be limited due to national frequency planning requirements. The user is responsible for respecting those rules.

Register Your Product:

Your product can be registered on our website at www.innotek.net

IMPORTANT ADVICE

1. Read the complete instructions and follow all directions. If you have any questions, please call 1-800-826-5527.
2. This device is intended for use only on dogs. Never attempt to use it for any purpose not described in this manual.

3. Never perform set-up procedures while the collar is on your dog.

4. Any collar worn for extended periods can cause a condition similar to bedsores, known as Pressure Necrosis. To reduce the possibility, you must do the following:

- Never leave the collar on the dog for more than 12 hours per day.
- Examine the dog's neck daily for any signs of a rash or a sore.
- Supervise your dog during the first 2 days of training.
- Check the fit to prevent excessive pressure; you should be able to insert one finger between the collar strap and your dog's skin.
- Wash the dog's neck area and the probes of the collar weekly with a wash cloth and mild hand soap; rinse thoroughly.
- If the condition persists beyond 24 hours, see your veterinarian.

5. Always use the rubber insulators between the collar strap and the insulated plastic probes.

6. Other collars and metal tags should be removed when using the Rugged All-Terrain Beeper.

7. Do not attempt to dismantle or repair any components of this system; doing so will void the warranty in full. The computerized circuitry should be serviced only by an authorized expert.

8. Realize that because dogs have unique temperaments, there is no way of knowing how your dog will react to the introduction of an audible tracking beeper. For the safety of your dog, a long lead should be used during initial training so you have control of the situation.

9. If you have reason to believe that your dog may pose a danger to others, harm itself, or react adversely to the collar, do not rely solely on this product to train your dog. If your dog shows signs of growling, snarling or biting while using the collar, stop immediately. Aggression in dogs has many causes. We recommend that you consult a knowledgeable professional dog trainer or animal behaviorist who has experience with aggressive dogs if your dog has shown any of these characteristics.



Innotek, Inc.
1-800-826-5527
www.innotek.net