

SAFE PETS

PetSafe[®]

HAPPY OWNERS

Comfort-Fit[™]

Bark Control

Operating and Training Guide

Please read this entire guide before beginning

Thank you for choosing PetSafe®, the #1 selling brand of electronic training solutions in the world. Our mission is to ensure your pet’s safety by providing you the tools and techniques to successfully train your pet. If you have any questions, please contact the Customer Care Center at 1-800-732-2677 or visit our website at www.petsafe.net.

Table of Contents

Components	3
Features	3
How the PetSafe Bark Control Collar™ Works.....	4
Key Definitions	4
Fit the Bark Control Collar.....	5
To Insert and Remove the Battery.....	7
What to Expect During Use of the Bark Control Collar	8
Regular Maintenance	8
Accessories	9
Frequently Asked Questions	9
Troubleshooting.....	10
Terms of Use and Limitation of Liability.....	10

“In a Tuskegee University study of adult shelter dogs wearing the PetSafe Bark Control Collar™ for six 30-minute sessions over two weeks, we detected no long-term adverse effects, and all dogs dramatically reduced their barking by the second day.”

Dr. Janet Steiss and Dr. Caroline B. Schaffer
Tuskegee University

Components

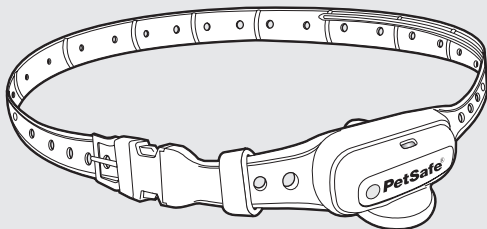

**PetSafe
Bark Control Collar™**



**Battery
(PetSafe® RFA-67)**



Operating Guide



**Warranty
Card**

Features

- 6 levels of Static Correction, automatically adjusts to your dog's temperament starting at the lowest level
- Water Resistant
- Low Battery Indicator Light
- Lifetime Limited Warranty

How the PetSafe Bark Control Collar™ Works

The Bark Control Collar™ has a unique patented sensor technique that provides the most reliable bark detection available. The Bark Control Collar uses both vibration and sound sensors to discriminate each bark from other external noises. A Static Correction is administered through the Contact Points only if both the vibration from the vocal cords and the sound from the bark match the bark sampling criteria. The Bark Control Collar starts with the lowest level of Static Correction and then increases through 6 levels each time your dog barks within 30 seconds of the previous bark. If your dog does not bark again within 30 seconds, the Bark Control Collar will reset itself to the lowest level of Static Correction. As a built-in safety feature, if your dog barks 15 times or more within a 50-second period, the Bark Control Collar will automatically shut off for 3 minutes.

Important:

- **Before playing with your dog, remove the Bark Control Collar.** The activity may cause your dog to bark, which could lead to him associating the play with the Static Correction.
- **Never leave the Bark Control Collar on your dog for more than 12 consecutive hours.**

Key Definitions

Indicator Light: Flashes once every five seconds during normal operation.

Sound Activated Sensor: Detects the sound of you dog's bark.

Sensor Probe: Detects the vibrations of your dog's barking. *Note: The Sensor Probe is not adjustable.*

Contact Points: Deliver the safe Static Correction.

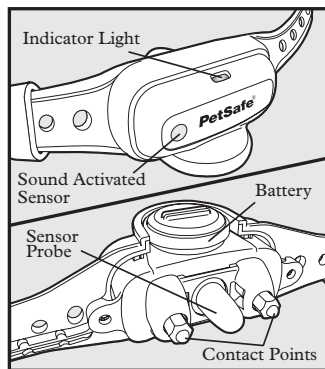

Fit the Bark Control Collar

Important: The proper fit and placement of your Bark Control Collar is important for effective operation. The Contact Points must have direct contact with your dog's skin on the underside of his neck.

To assure a proper fit, please follow these steps:

1. Make sure that the battery is not installed in the Bark Control Collar.
2. Have your dog standing comfortably.
3. Center the Contact Points underneath your dog's neck, touching the skin.

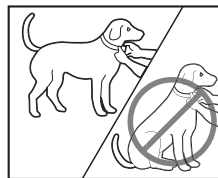

Note: It is sometimes necessary to trim the hair around the Contact Points to make sure that contact is consistent.

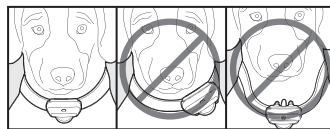

4. The PetSafe QuickFit™ Collar is designed so you can quickly attach and remove the Bark Control Collar from your dog while maintaining the desired fit.

- a. With the Snap Buckle fastened, thread the collar through the Metal Buckle.

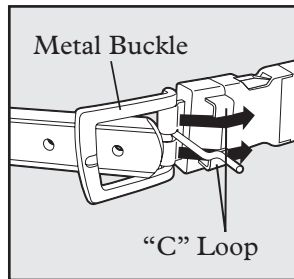
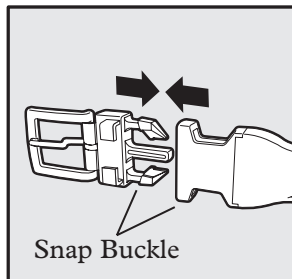

- b. Slide the excess collar through the "C" Loop on top of the Snap Buckle. This will hold the collar in place.

- c. Once the collar fit is determined, simply use the Snap Buckle to remove and replace the collar.

5. The Bark Control Collar should fit snugly, yet loose enough to allow one finger to fit between a Contact Point and your dog's neck. Allow your dog to wear the collar for several minutes, then recheck the fit. Check the fit again as your dog becomes more comfortable with the Bark Control Collar.

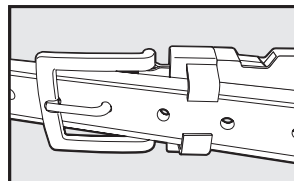

6. Trim the collar as follows:

- a. Mark the desired length of the collar with a pen. Allow for growth if your dog is young or grows a thick winter coat.
- b. Remove the Bark Control Collar from your dog and cut off excess.

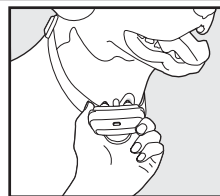

ID Tag Ring

Use the ID Tag Ring to attach your dog's ID tags to the collar. Simply place the ID Tag Ring through one of the holes on your collar. Make sure to place the Ring far enough from receiver housing so that tags will not hit the Receiver or the Contact Points.

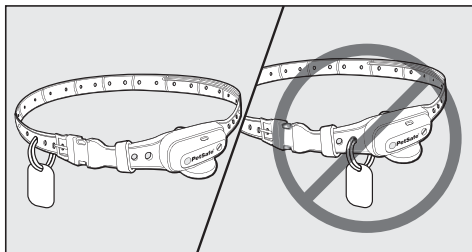

Important: Do not attach a leash to the collar. This can result in pulling the Contact Points too tightly against your pet's neck. Attach a leash to a separate, non-metallic collar or harness, making sure the extra collar does not put pressure on the Contact Points.

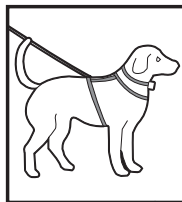

Important: For comfort, safety and effectiveness of product, please ensure the following:

- Check the fit to prevent excessive pressure by being able to insert one finger between the Contact Point and your pet's skin.
- Your pet must be carefully examined daily for any signs of a rash or sore.
- If a rash or sore is observed, discontinue the use of the Bark Control Collar for a few days.
- If the condition persists beyond 48 hours, see your veterinarian.
- Your pet's neck and the Contact Points must be washed weekly with a wash cloth and mild hand soap, then rinsed thoroughly.

A condition called Pressure Necrosis, which is a devitalization of the skin due to excessive and prolonged contact against the Contact Points, may occur if the steps above are not followed.

To Insert and Remove the Battery

Note: Do not install the battery while the Bark Control Collar is on your dog.

This Bark Control Collar utilizes a replaceable PetSafe® battery (RFA-67). This unique battery is designed to make battery replacement easier and increase water protection.

To insert the battery, align the symbols on the battery (arrow) and Bark Control Collar (triangle). Use a large coin to turn the battery clockwise until the arrow lines up with the lock symbol on the housing.

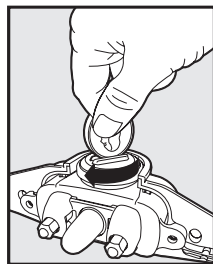
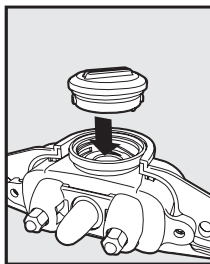

To remove the battery, turn the battery counter-clockwise using a large coin. **DO NOT** attempt to cut into or pry open the battery. Be sure to discard the used battery properly.

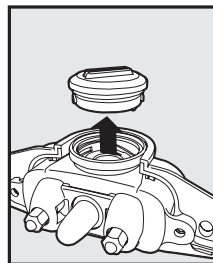
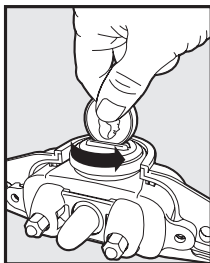

A replacement PetSafe® battery (RFA-67) can be found at many retailers. Contact the Customer Care Center at 1-800-732-2677 or visit our web site at www.petsafe.net to locate a retailer near you.

Battery Life

Average battery life is 3 to 6 months, depending on how often your dog barks. However, due to greater use during your dog's training, your first battery may not last as long as replacement batteries. To conserve battery life, remove the battery when the Bark Control Collar is not in use.

Indicator Light

During normal operation, the Indicator Light flashes once every 5 seconds. As the product is used, the battery will be drained to a weakened state. At this point, the Indicator Light will stop flashing to indicate it is time to change the battery.

What to Expect During Use of the Bark Control Collar

Important: Do not leave your dog alone the first few times he receives a Static Correction.

Place the Bark Control Collar properly on your dog and wait nearby until he barks. Most dogs will understand very quickly that the Bark Control Collar is disrupting their urge to bark and will relax and stop barking. Because the Static Correction from the Bark Control Collar may be surprising or startling at first, some dogs may bark more at the initial correction.

On rare occasions, a dog may get into a bark-correction-bark-correction cycle. If this happens, reassure your dog with calm, soothing tones. As your dog relaxes, he will understand that if he becomes quiet, he will not receive any more Static Corrections. The small minority of dogs that have this reaction will only have it the first time they wear the Bark Control Collar.

You should notice a reduction in your dog's barking within the first couple of days that he wears the Bark Control Collar. At this point, it is important to remember the learning process is still not complete. Dogs will "test" this new learning experience and will increase their attempts to bark. This usually occurs during the second week a dog wears the Bark Control Collar. If this does occur, remain consistent and do not alter your use of the Bark Control Collar. You must place the Bark Control Collar on your dog in every situation when you expect him to be quiet. If your dog is not wearing the Bark Control Collar, he may resume barking and his learning would suffer a setback.

Regular Maintenance

- Check Contact Points for tightness weekly
Note: Do not adjust the factory preset Sensor Probe.
- Clean Contact Points with alcohol weekly.
Note: Remove the battery before touching the Contact Points.
- Check your dog's neck for irritation and wash neck weekly.

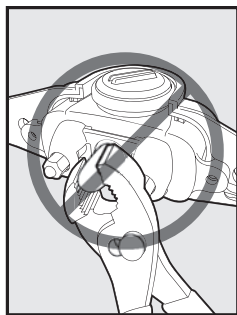

Accessories

To purchase additional accessories for your PetSafe Bark Control Collar™, contact the Customer Care Center at 1-800-732-2677 or visit our website at www.petsafe.net to locate a retailer near you.

Component	Part Number
Battery - two pack	RFA-67D-11

If the collar breaks, you do not have to replace the whole unit. The collar is replaceable; however under normal circumstances there is no need to separate the collar and receiver. Please contact the Customer Care Center for replacement collar and instructions.

Frequently Asked Questions

Will my dog stop barking completely?	<ul style="list-style-type: none">• The Bark Control Collar effectively and humanely stops all barking when it is worn. It should only be worn during periods of unwanted barking.
My dog has a sensitive nature. Can I lower the Static Correction level?	<ul style="list-style-type: none">• You can obtain a resistor to reduce the Static Correction level by contacting the Customer Care Center at 1-800-732-2677.
Will another dog's bark set off the Bark Control Collar?	<ul style="list-style-type: none">• No.
Is the Bark Control Collar safe and humane?	<ul style="list-style-type: none">• Yes. The Bark Control Collar is designed to get your dog's attention, not to punish him. However, the initial Static Correction may startle your dog.
Will the Bark Control Collar work for my dog?	<ul style="list-style-type: none">• The Bark Control Collar is safe and effective for all breeds and sizes of dogs, though it may be too large for dogs under 8 pounds to wear comfortably.
Can I attach a leash to the Bark Control Collar?	<ul style="list-style-type: none">• No. This can result in pulling the Contact Points too tightly against your dog's neck. Attach a leash to a separate, non-metallic collar or a harness, making sure the extra collar does not put pressure on the Contact Points.

Troubleshooting

My dog keeps barking (does not respond to the Static Correction).	<ul style="list-style-type: none">• Tighten the Bark Control Collar and/or trim your dog's hair where the Contact Points touch his neck to ensure good skin contact.• Replace the battery.• If your dog still does not respond, contact the Customer Care Center at 1-800-732-2677.
The Indicator Light stopped flashing.	<ul style="list-style-type: none">• Ensure that the battery is properly installed.• Replace the battery.• If the Indicator Light still does not flash, contact the Customer Care Center at 1-800-732-2677.

Terms of Use and Limitation of Liability

1. Terms of Use

This Product is offered to you conditioned upon your acceptance without modification of the terms, conditions and notices contained herein. Usage of this Product implies acceptance of all such terms, conditions, and notices.

2. Proper Use

This Product is designed for use with pets where training is desired. The specific temperament of your pet may not work with this Product. We recommend that you not use this Product if your pet is less than 8 pounds or if your pet is aggressive. If you are unsure whether this is appropriate for your pet please consult your veterinarian or certified trainer.

Proper use includes reviewing the entire Guide provided with your Product and any specific Caution statements.

3. No Unlawful or Prohibited Use

This Product is designed for use with pets only. This pet training device is not intended to harm, injure or provoke. Using this Product in a way that is not intended could result in violation of Federal, State or local laws.

4. Limitation of Liability

In no event shall Radio Systems Corporation be liable for any direct, indirect, punitive, incidental, special or consequential damages, or any damages whatsoever arising out of or connected with the use or misuse of this Product. Buyer assumes all risks and liability from the use of this Product.

5. Modification of Terms and Conditions

Radio Systems Corporation reserves the right to change the terms, conditions and notices under which this Product is offered.



300-414

**Tested To Comply
With FCC Standards**

FOR HOME OR OFFICE USE

Radio Systems Corporation
10427 Electric Avenue
Knoxville, TN 37932
1-800-732-2677
www.petsafe.net
400-714