

SAFE PETS

PetSafe[®]

HAPPY OWNERS

Comfort-Fit[™]

Deluxe
**In-Ground
FENCE**[™]

Operating and
Training Guide

Please read this entire
guide before beginning

How the System Works

The PetSafe In-Ground Fence™ has been proven safe, comfortable, and effective for all pets over 8 pounds. The system works by producing a radio signal from the Fence Transmitter through the Boundary Wire. The Boundary Wire is buried or attached to a fixed object to enclose the Pet Area. You temporarily define this Pet Area with Boundary Flags for a visual aid in training your pet. Your pet wears a Receiver Collar with Contact Points that touch his neck, and, once trained, is allowed to roam freely in the Pet Area. When your pet reaches the Warning Zone, the Receiver Collar gives a warning beep. If your pet continues into the Static Correction Zone, a safe Static Correction will be delivered through the Contact Points to get his attention until he returns to the Pet Area.

Prepare the Receiver Collar

To Insert and Remove the Battery

Note: Do not install the battery while the Receiver Collar is on your pet.

This Receiver Collar utilizes a replaceable PetSafe® battery (RFA-67). This unique battery is designed to make battery replacement easier and increase water protection.

To insert the battery, align the symbols on the battery (arrow) and Receiver Collar (triangle). Using the edge of the Test Light Tool as shown, turn the battery clockwise until the arrow lines up with the lock symbol on the housing (**A, B**).

To remove the battery, turn the battery counter-clockwise using the edge of the Test Light Tool as shown (**C, D**).

DO NOT attempt to cut into or pry open the battery. Be sure to discard the used battery properly.

A replacement PetSafe® battery (RFA-67) can be found at many retailers. Contact the Customer Care Center at 1-800-732-2677 or visit our web site at www.petsafe.net for a list of common retailers.

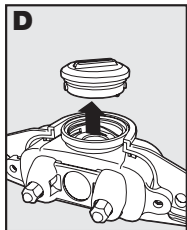
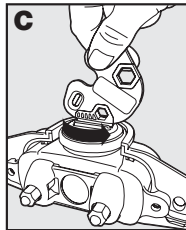
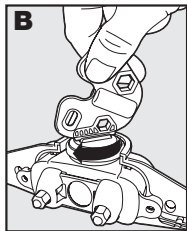
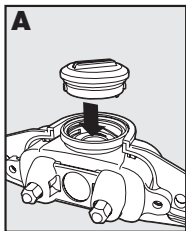

To Set the Static Correction Level

Read all steps before attempting to set the Static Correction Level.

1. With the battery installed, press the Correction Level Button and release when the Receiver Indicator Light lights up (E).
2. The Receiver Indicator Light will emit a number of flashes representing the Static Correction Level (F).
3. Increase the Static Correction Level by pressing and releasing the Correction Level Button within 5 seconds of the previous flashes.

The Static Correction Levels increase from 1 to 5. Pushing the Correction Level Button while the Receiver Collar is on level 5 will cause the Receiver Collar to revert to level 1. Refer to the Function and Response Table to choose the Static Correction level that best fits your pet.

The Receiver Collar is equipped to automatically increase the level of Static Correction the longer your pet remains in the Static Correction Zone if the collar is set at level 2 or above.

The Receiver Indicator Light acts as a low battery indicator, flashing every 4 to 5 seconds when battery replacement is required.

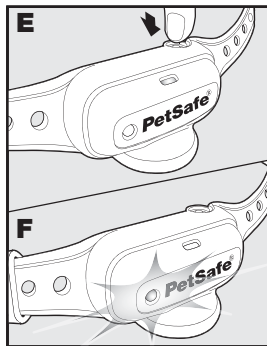

Function and Response Table

Indicator Light Response	Static Correction Level	Receiver Collar Function	Temperament of Pet
1 Flash	1	No Static Correction, Beep Only	
2 Flashes	2	Low Static Correction	Timid
3 Flashes	3	Medium Static Correction	Timid or Average
4 Flashes	4	Medium High Static Correction	Average or High Energy
5 Flashes	5	High Static Correction	High Energy
Flashes once every 4 to 5 seconds	Low Battery		

Note: Begin training with Static Correction Level 2 and only increase if your pet does not respond to the Static Correction.

Fit the Receiver Collar

Important: The proper fit and placement of your Receiver Collar is important for effective operation. The Contact Points must have direct contact with your pet's skin on the underside of his neck.

To assure a proper fit, please follow these steps:

1. Make sure that the battery is not installed in the Receiver Collar.
2. Have your pet standing comfortably (G).
3. Center the Contact Points underneath your pet's neck, touching the skin (H).

Note: It is sometimes necessary to trim the hair around the Contact Points to make sure that contact is consistent.

4. The PetSafe QuickFit™ Collar is designed so you can quickly attach and remove the Receiver Collar from your pet while maintaining the desired fit.

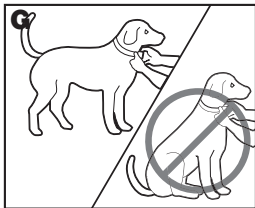

- a. With the Snap Buckle fastened (I), thread the collar through the Metal Buckle (J).

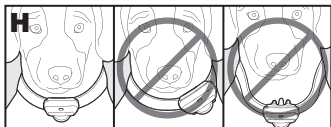

- b. Slide the excess collar through the "C" Loop on top of the Snap Buckle (K). This will hold the excess collar in place.

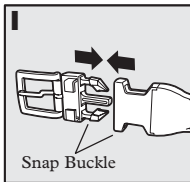

- c. Once the collar fit is determined, use the Snap Buckle to remove and replace the collar.

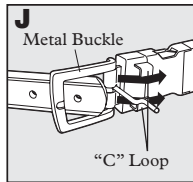

5. The Receiver Collar should fit snugly, yet loose enough to allow one finger to fit between a Contact Point and your pet's neck (L). Allow your pet to wear the collar for several minutes, then recheck the fit. Check the fit again as your pet becomes more comfortable with the Receiver Collar.

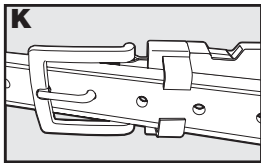

6. Trim the collar as follows:

- Mark the desired length of the collar with a pen. Allow for growth if your pet is young or grows a thick winter coat.
- Remove the Receiver Collar from your pet and cut off excess.

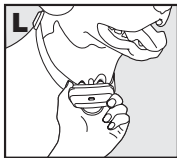

ID Tag Ring

Use the ID Tag Ring to attach your pet's ID tags to the collar. Simply place the ID Tag Ring through one of the holes on your collar. Make sure to place the Ring far enough from receiver housing so that tags will not hit the Receiver or the Contact Points (M).

Important: Do not attach a leash to the collar. This can result in pulling the Contact Points too tightly

against your pet's neck. Attach a leash to a separate, non-metallic collar or harness, making sure the extra collar does not put pressure on the Contact Points.

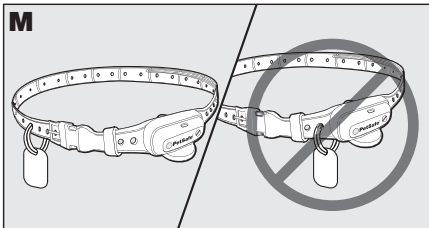

Important: For comfort, safety and effectiveness of product, please ensure the following:

- **Check the fit to prevent excessive pressure by being able to insert one finger between the Contact Point and your pet's skin.**
- **Your pet must be carefully examined daily for any signs of a rash or sore.**
- **If a rash or sore is observed, discontinue the use of the Receiver Collar for a few days.**
- **If the condition persists beyond 48 hours, see your veterinarian.**
- **Your pet's neck and the Contact Points must be washed weekly with a wash cloth and mild hand soap, then rinsed thoroughly.**

A condition called Pressure Necrosis, which is a devitalization of the skin due to excessive and prolonged contact against the Contact Points, may occur if the steps above are not followed.

Taking Your Pet Out of the Pet Area

Important: Remove the Receiver Collar and leave it in the Pet Area.

Once your pet learns the Boundary Zone, he will be reluctant to cross it for walks or car rides.

Option 1: Replace the Receiver Collar with a regular collar. Put your pet in a car that is within the Pet Area and drive him out of the Pet Area.

Option 2: Replace the Receiver Collar with a regular collar and leash. Walk your pet out of the Pet Area while giving a command such as “OK” at a specific place of the Boundary Zone (the end of your driveway, sidewalk, etc.). Always leave the Pet Area with a leash at this place and your pet will associate leaving the Pet Area only on a leash, only at this place, and only with a person. You may initially need to convince your pet to leave the Pet Area with a food treat and lots of praise.

Note: You may also carry your pet out of the Pet Area.

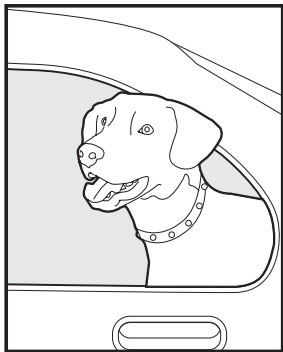

Troubleshooting

Receiver Collar is not beeping or correcting.

- Check battery to make sure it is installed properly.
- Check that both lights are lit on the Fence Transmitter. If not, perform the “Short Loop Test”.

The Receiver Collar is beeping, but the pet is not responding to the Static Correction.

- Make sure the Static Correction Level is set at 2 or above.
- Test the Receiver Collar with the Test Light.
- If the Test Light flashes, check the fit of the Receiver Collar.
- Trim your pet’s hair where the Contact Points touch his neck.
- Increase the Static Correction Level.
- Repeat training steps to reinforce training.
- Purchase a stronger Receiver Collar by contacting the Customer Care Center at 1-800-732-2677.

The Receiver Collar has to be held on top of the Boundary Wire to activate.

- Replace battery.
- Adjust Boundary Width Control knob clockwise to increase the distance from the Boundary Wire that the Receiver Collar activates. You can also adjust the Boundary Control Switch to another setting.
- If using a Double Loop, make sure Boundary Wires are separated 3 to 5 feet.
- If the Receiver Collar still has to be held on top of the Boundary Wire, perform the “Short Loop Test.”

Test Light Instructions

1. Set the Correction Level to 2 or above.
2. Hold the Test Light Contacts to the Contact Points.
3. Walk toward the Boundary Wire holding the Receiver collar at your pet's neck level until the Test Light flashes.

Note: If the Test Light does not flash, install a new battery and re-test. If Test Light still does not flash, contact the Customer Care Center at 1-800-732-2677.

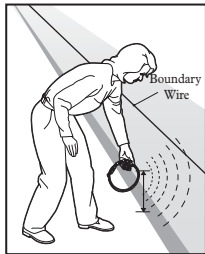
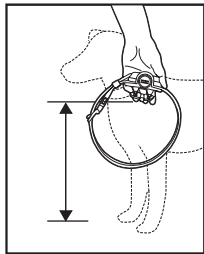
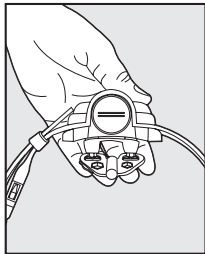

Terms of Use and Limitation of Liability

1. Terms of Use

This Product is offered to you conditioned upon your acceptance without modification of the terms, conditions and notices contained herein. Usage of this Product implies acceptance of all such terms, conditions, and notices.

2. Proper Use

This Product is designed for use with pets where training is desired. The specific temperament of your pet may not work with this Product. We recommend that you not use this Product if your pet is less than 8 pounds or if your pet is aggressive. If you are unsure whether this is appropriate for your pet, please consult your veterinarian or certified trainer.

Proper use includes reviewing the entire Guide provided with your Product and any specific Caution statements.

3. No Unlawful or Prohibited Use

This Product is designed for use with pets only. This pet training device is not intended to harm, injure or provoke. Using this Product in a way that is not intended could result in violation of Federal, State or local laws.

4. Limitation of Liability

In no event shall Radio Systems Corporation be liable for any direct, indirect, punitive, incidental, special or consequential damages, or any damages whatsoever arising out of or connected with the use or misuse of this Product. Buyer assumes all risks and liability from the use of this Product.

5. Modification of Terms and Conditions

Radio Systems Corporation reserves the right to change the terms, conditions and notices under which this Product is offered.

Caution

The PetSafe In-Ground Fence™ is NOT a solid barrier. The system is designed to act as a deterrent to remind pets by electric stimulation to remain in the boundary established. It is important that you reinforce training with your pet on a regular basis. Since the tolerance level to electrical stimulation varies from pet to pet, Radio Systems Corporation CANNOT guarantee that the system will, in all cases, keep a pet within the established boundary. Not all pets can be trained to avoid crossing the boundary! Therefore, if you have reason to believe that your pet may pose a danger to others or harm himself if he is not kept from crossing the boundaries, you should NOT rely solely upon the PetSafe In-Ground Fence™ to confine your pet. Radio Systems Corporation shall NOT be liable for any property damage, economic loss or any consequential damages, sustained as a result of any animal crossing the boundary.

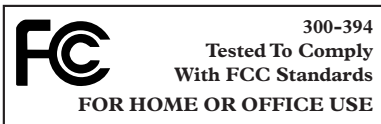

This device complies with part 15 of the FCC Rules. Operation is subject to the following two conditions: (1) This device may not cause harmful interference, and (2) this device must accept any interference received, including interference that may cause undesired operation.

Radio Systems Corporation
10427 Electric Avenue
Knoxville, TN 37932
1-800-732-2677
www.petsafe.net
400-726

©Copyright 2005 Radio Systems Corporation